

# IPCO PREFORMED DOOR JAMB END DAM IN STAINLESS STEEL

## 1. Product Name

IPCO Preformed Door Jamb End Dam in stainless steel

## 2. Manufacturer

Illinois Products Corporation (IPCO)  
423 Joseph Drive  
South Elgin, IL 60177-2268  
800-383-8183; 847-289-2800  
847-289-2804 (fax)  
www.illinoisproducts.com

## 3. Product Description

The IPCO Preformed Door Jamb End Dam is specifically designed to address the bottom of door openings, especially sliding glass doors on balconies and patios. This has been a typical source of moisture problems in construction that is now eliminated by use of the IPCO Preformed Door Jamb End Dam.

The IPCO Preformed Door Jamb End Dam is an important part of the comprehensive IPCO Flashing System, providing another element which ensures continuous moisture barrier protection in masonry walls. The IPCO Flashing System (consisting of self-adhesive rubberized asphalt flashing, preformed corners and end dams in self-adhesive rubberized asphalt, stainless steel or copper, drip edge in stainless steel or copper, termination bar and cavity bridge) is the most comprehensive flashing system available.

The IPCO Preformed Door Jamb End Dam diverts water back to the weep hole and away from the juncture of the masonry and door frame. It's one diagonal wall makes it unobtrusive and completely effective.

## 4. Technical Data

- Material: Type 304 grade stainless steel, 27 gauge (15mil)
- Dimensions: Fabricated to meet field specifications

## 5. Installation

The substrate surface should be cleaned of dust, dirt and foreign matter. All sharp protrusions should be eliminated and surfaces should be dry. All data sheets and installation guides for the entire IPCO Flashing System should be read and understood by all personnel prior to installation of the IPCO Preformed Door Jamb End Dam.

The IPCO Preformed Door Jamb End Dam should be installed after the drip edge, but prior to the installation of the self-adhesive rubberized asphalt flashing material. The end dam should extend from the bend point on the drip edge at the face of masonry, past the back face of the exterior wythe, and preferably to the face of the backup wall. Use construction adhesive to adhere the end dam and drip edge to the masonry, and to provide additional sealing properties between the flashing and the substrate.

Do not use silicone or polysulfide sealants in contact with IPCO Flashing material. For additional information on the installation of the IPCO Flashing System, refer to the IPCO

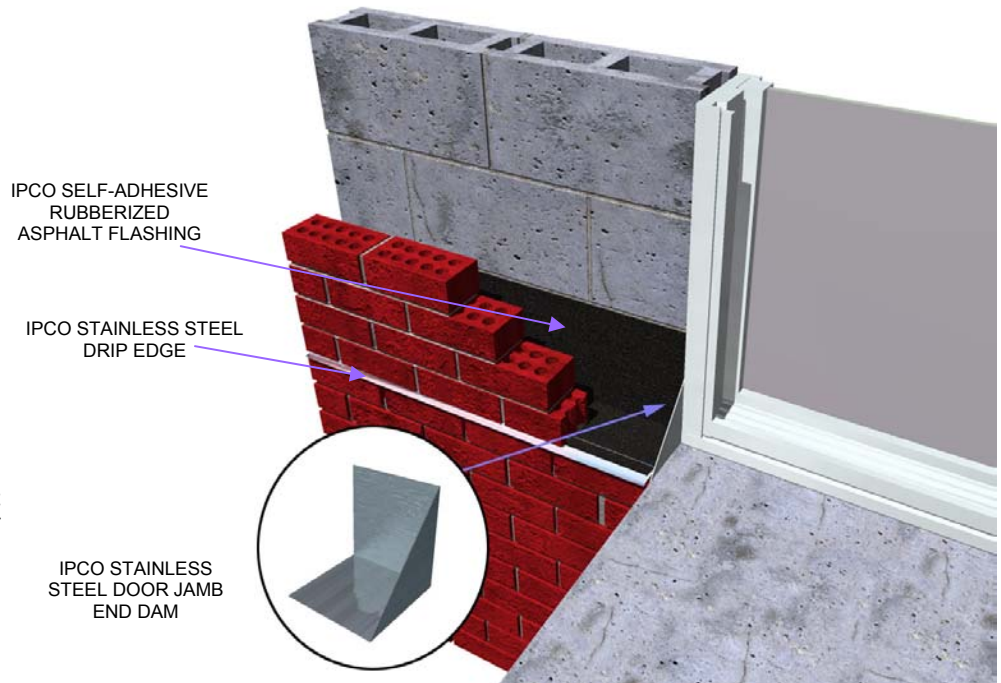

Flashing System data sheet as well as the data sheets for each of the components of the IPCO Flashing System.

## 6. Availability and Cost

All Illinois Products Corporation masonry products and cost information are available through a nationwide network of masonry and building supply distributors.

## 7. Warranty

The recommendations and properties attributed to the products are based upon what is believed to be reliable information. Illinois Products Corporation warrants materials to be of good quality and will replace unused material proven to be defective. No expressed or implied warranty of installed material is made because satisfactory results depend not only on product quality but also upon factors that are beyond IPCO's control.

## 8. Maintenance

No maintenance is required after proper installation.

## 9. Technical Services

Contact the manufacturer for any required technical services. Details and suggested application drawings are available on each individual product data sheet. IPCO Material Safety Data Sheets should be read and understood by all personnel before using the products.

## 10. Filing Systems

Product information is available from the manufacturer in the following formats:

- Complete IPCO product line catalog in printed and CD formats
- Online access to all data sheets at: [www.illinoisproducts.com](http://www.illinoisproducts.com)

Revised 01/2007



ILLINOIS PRODUCTS CORPORATION  
423 Joseph Drive South Elgin, IL 60177

[www.illinoisproducts.com](http://www.illinoisproducts.com)  
800-383-8183 847-289-2804 fax