

# IPCO PREFORMED FLASHING CORNERS AND END DAMS IN RIGID COPPER AND RIGID STAINLESS STEEL

## 1. Product Name

IPCO Preformed Flashing Corners and End Dams in copper and stainless steel

## 2. Manufacturer

Illinois Products Corporation (IPCO)  
423 Joseph Drive  
South Elgin, IL 60177-2268  
800-383-8183; 847-289-2800  
847-289-2804 (fax)  
www.illinoisproducts.com

## 3. Product Description

The IPCO Preformed Flashing Corner in stainless steel or copper provide maximum protection against moisture infiltration at the outside and inside corner condition. The rigid stainless steel or copper corner and end dam will add an extra layer of protection to the flashing system.

The preformed technology of the IPCO Preformed Flashing Corner and End Dam eliminates the series of cuts, folds, flaps and patching required to field fabricate an inside or outside corner. This time-consuming and difficult procedure often results in a less than desirable corner and end-flashing condition. Using IPCO Preformed Flashing Corners and End Dams will also save valuable and expensive field labor hours.

IPCO Preformed Corners and End Dams in Copper work extremely well with copper laminate flashing, which is difficult to bend and shape. Using the preformed corners eliminates errors and provides for a more effective and economical corner and end-flashing condition.

IPCO Preformed Corners and End Dams in stainless steel and copper work extremely well with IPCO Flashing in self-adhesive rubberized asphalt. The adhesive of the flashing adheres completely to the stainless steel or copper, forming a continuous barrier to moisture penetration with the added protection of a rigid material in the corner conditions.

## 4. Technical Data

### IPCO PREFORMED FLASHING CORNERS AND END DAMS IN STAINLESS STEEL

- Material: Type 304 stainless steel (15mil thickness)
- Dimensions of End Dams: 90° corners in 3"x3"x3" and 6"x6"x6" standard; special dimensions available upon request
- Dimensions of Inside Corners: 90° corners in 8"x8"x8" standard; special dimensions available upon request
- Dimensions of Outside Corners: Type A: 90° outside corners with 7" top x 8" vertical x 7" base. Also available in Type B (no top)

### IPCO PREFORMED FLASHING CORNERS AND END DAMS IN COPPER

- Material: 12oz copper (15mil)
- Dimensions of End Dams: 90° corners in

## CORNERS

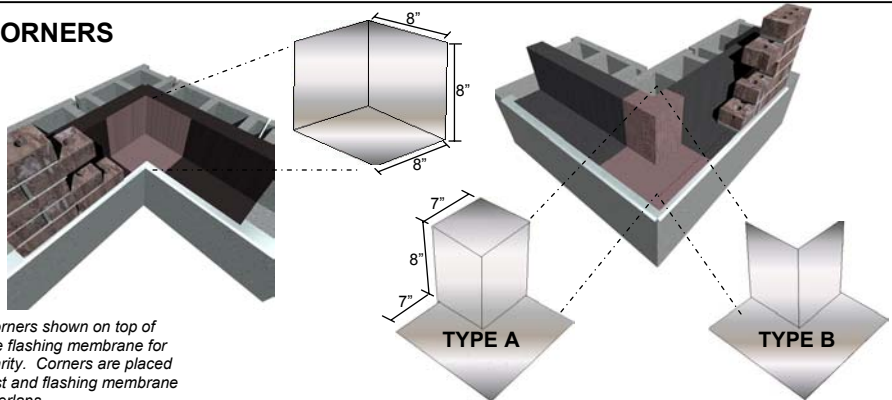

Corners shown on top of the flashing membrane for clarity. Corners are placed first and flashing membrane overlaps.

## END DAMS

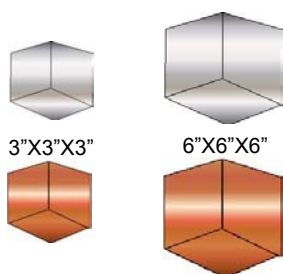

Also available in self-adhesive rubberized asphalt!

3"x3"x3" and 6"x6"x6" standard; special dimensions available upon request

- Dimensions of Inside Corners: 90° corners in 8"x8"x8" standard; special dimensions available upon request
- Dimensions of Outside Corners: Type A: 90° outside corners with 7" top x 8" vertical x 7" base. Also available in Type B (no top)

## 5. Installation

Read and understand the installation requirements of the flashing material being used prior to installation of the corners and end dams. It is important to understand how to properly prepare the substrate surface as required by the flashing product manufacturer. Once substrate has been prepared, install drip edge in a bead of sealant. Preformed Corners and End Dams are to be laid in a bed of construction adhesive to hold in place, and then overlapped with the flashing material. Any exposed edges of the stainless steel or copper corner or end dam must be sealed in order to prohibit moisture from getting behind or underneath the corner or end dam. Only use sealants that are compatible with the copper or stainless steel corner or end dam, as well as the flashing material being used. Refer to each specific data sheet for each product being provided for additional information and technical data. If using IPCO Flashing in self-adhesive rubberized asphalt, refer to the data sheet provided in the catalog for installation instructions and requirements.

## 6. Availability and Cost

All Illinois Products Corporation products and prices are available through a nationwide network of masonry and building supply distributors.

## 7. Warranty

The recommendations and properties attributed to the products are based upon what is believed to be reliable information. Illinois Products Corporation warrants materials to be of good quality and will replace unused material proven to be defective. No expressed or implied warranty of installed material is made because satisfactory results depend not only on product quality but also upon factors that are beyond IPCO's control.

## 8. Maintenance

No maintenance is required after proper installation.

## 9. Technical Services

Contact the manufacturer for any required technical services. Details and suggested application drawings are available on each individual product data sheet. IPCO Material Safety Data Sheets should be read and understood by all personnel before using the products.

## 10. Filing Systems

Product information is available from the manufacturer in the following formats:

- Complete IPCO product line catalog in printed and CD formats
- Online access to all data sheets at: [www.illinoisproducts.com](http://www.illinoisproducts.com)



ILLINOIS PRODUCTS CORPORATION  
423 Joseph Drive  
South Elgin, IL 60177

[www.illinoisproducts.com](http://www.illinoisproducts.com)  
Phone: 800-383-8183  
Fax: 847-289-2804